

P6K-36-SERIES-5BB

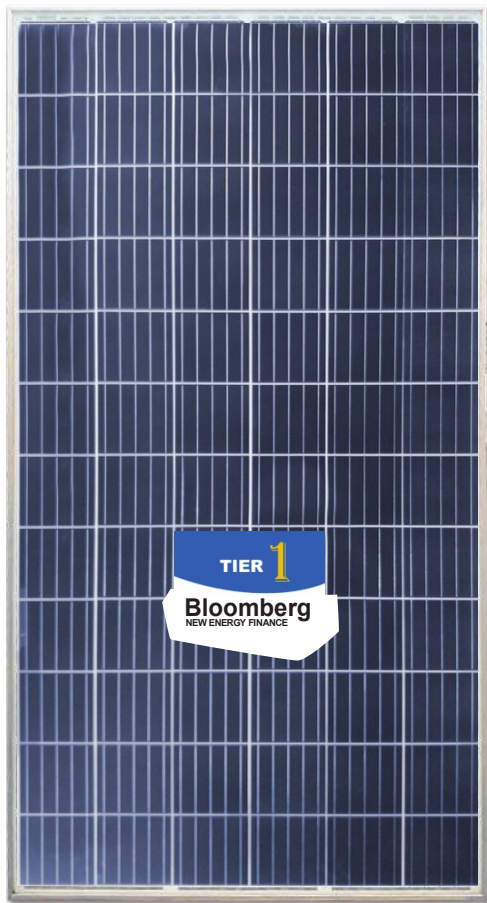

156.75P



-  Average cell efficiency up to 19.2%.
Excellent optical performance
-  Positive tolerance 0~5W
Reliability for output performance
-  10 Years
10 years for product
25 years linear Warranty
-  Residential roof top systems
On/Off-grid commercial systems
On/Off-grid utility systems
-  More Efficient
No UV cut off
Higher power output
-  More Reliable
PID free & snail cracks free.
Stable encapsulating material
EVA FREE

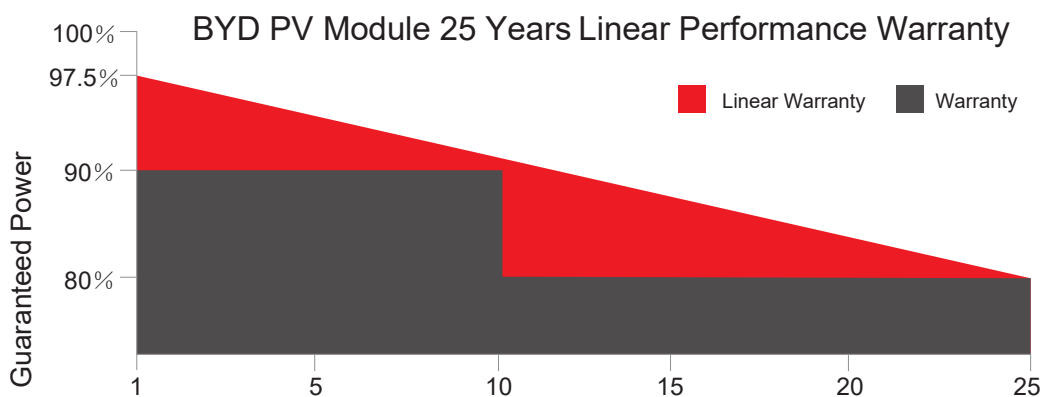

ABOUT BYD

BYD (HK:1211), one of the world's top PV manufacturers, produces from wafer to module, committing to high quality sustainable products and continuous improvement. Integrating with Electrical Vehicles and Battery Energy Storage technology makes BYD the world-leading solution provider from energy generating to consumption and storage.

P6K-36-SERIES-5BB

310-340W

156.75P

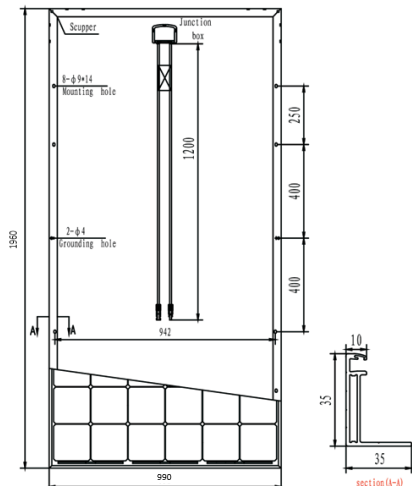

MECHANICAL SPECIFICATIONS

Cell	Poly-crystalline	156.75×156.75mm / 6.17 inch
No. of Cells	72 (6×12) pcs	
Dimension of Module	1960×990×35mm / 77.24×39.0×1.38 inch	
Weight	22.1 kg / 48.62 lbs	
Front Glass	3.2 mm tempered glass with AR Coating	
Frame	Anodized aluminum alloy	
Junction Box	IP67	
Plug Connector	IP67	
Bypass-Diodes	3 pcs	
Type of Connector	MC4-compatible	
Cable Section Area	4 mm ² / 0.0062 Sq in	
Cable Length	2×1200 mm / 2×47.2 inch	

TEMPERATURE COEFFICIENTS

Nominal Operating Cell Temperature (NOCT)	45°C± 2°C
Short-Circuit Current Temperature Coefficient	0.07%/°C
Open-Circuit Voltage Temperature Coefficient	-0.31%/°C
Peak Power Temperature Coefficient	-0.39%/°C

PACKAGE INFORMATION

Package	40' HC
Pcs / Pallet	30
Pallet / Container	22
Pcs / Container	660

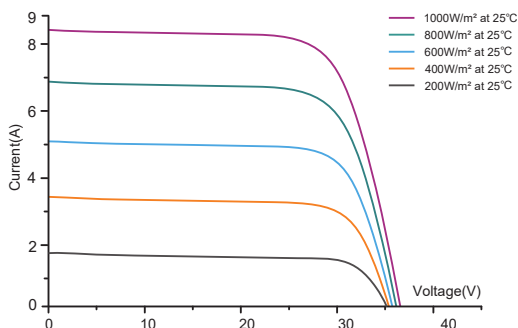

STC

Module Type	310P6K-36	315P6K-36	320P6K-36	325P6K-36	330P6K-36	335P6K-36	340P6K-36
Open Circuit Voltage (Voc)	45.79 V	46.09 V	46.39 V	46.69 V	46.98 V	47.28 V	47.58 V
Maximum Operating Voltage (Vmp)	36.38 V	36.58 V	36.78 V	36.98 V	37.16 V	37.35 V	37.53 V
Short Circuit Current (Isc)	8.99 A	9.07 A	9.15 A	9.23 A	9.31 A	9.39 A	9.47 A
Maximum Operating Current (Imp)	8.52 A	8.61 A	8.70 A	8.79 A	8.88 A	8.97 A	9.06 A
Maximum Power in STC (Pmax)	310 Wp	315 Wp	320 Wp	325 Wp	330 Wp	335 Wp	340 Wp
Module Efficiency	15.9%	16.2%	16.4%	16.7%	17.0%	17.2%	17.5%
Operating Temperature	-40°C~85°C						
Max.Fuse Current Rating	15 A						
Maximum System Voltage	1500 VDC						
Power Tolerance	0~5 W						
Application Classes	Class A						

STC: IRRADIANCE 1000W/m², Module Temperature 25°C, AM=1.5 Ave. efficiency reduction of 4.5% at 200W/m²

NOCT

Module Type	310P6K-36	315P6K-36	320P6K-36	325P6K-36	330P6K-36	335P6K-36	340P6K-36
Open Circuit Voltage (Voc)	42.2 V	42.5 V	42.8 V	43.1 V	43.4 V	43.7 V	43.9 V
Maximum Operating Voltage (Vmp)	33.8 V	34.0 V	34.3 V	34.5 V	34.8 V	35.1 V	35.3 V
Short Circuit Current (Isc)	7.29 A	7.36 A	7.42 A	7.49 A	7.54 A	7.60 A	7.66 A
Maximum Operating Current (Imp)	6.77 A	6.83 A	6.90 A	6.96 A	7.01 A	7.08 A	7.14 A
Maximum Power in STC (Pmax)	228.8 Wp	232.6 Wp	236.4 Wp	240.4 Wp	244.2 Wp	248.1 Wp	251.9 Wp

NOCT: open-circuit module operation temperature at 800W/m² irradiance, 20°C ambient temperature, 1m/s wind speed.



BYD ENERGY DO BRASIL

Av. Antônio Buscato, 230 / Terminal Intermodal de Cargas, Campinas

Build Your Dreams

T +55-19-3514 2550
0800 942 8088

@ vendas@byd.com
sac@byd.com

e <http://en.byd.com/br/>